

**PHILIPPINE
PORTS
AUTHORITY**



PORT MANAGEMENT OFFICE - MARINDUQUE/AQUEZON

CONSTRUCTION DRAWINGS

**MAINTENANCE OF PORT
OPERATIONS BUILDING**

PORT OF LUCENA

LUCENA CITY





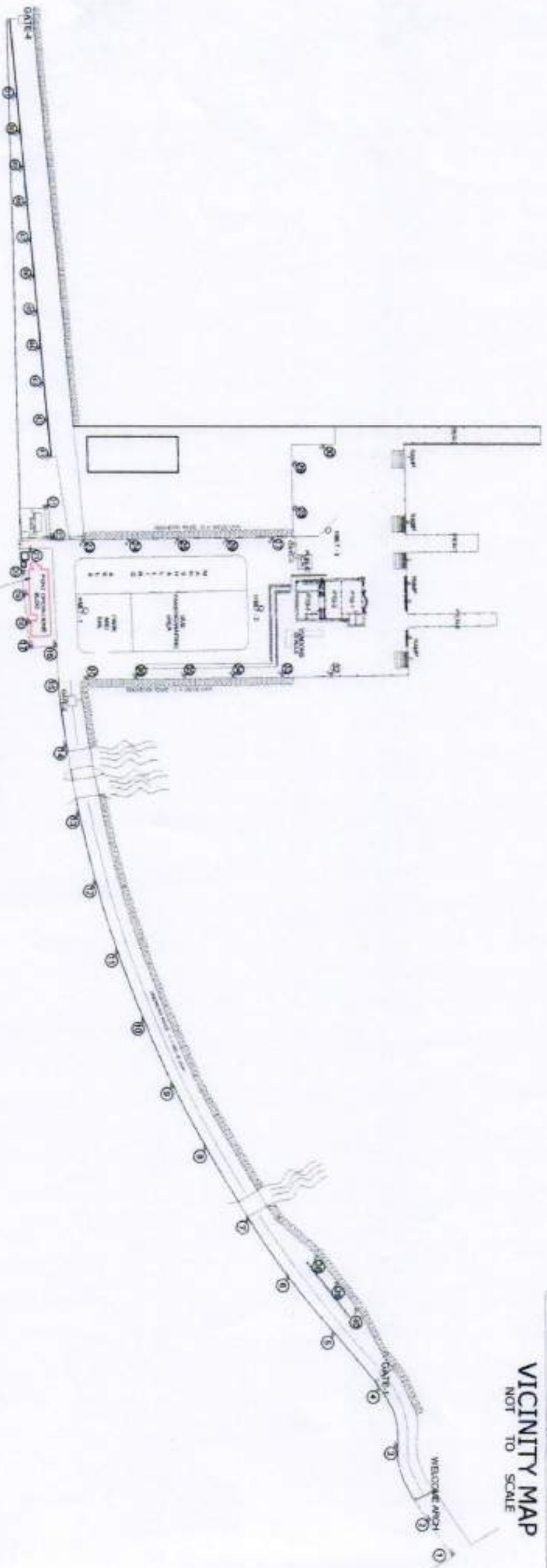

VICINITY MAP
NOT TO SCALE



- MAINTENANCE OF POB BUILDING
- REPLACEMENT OF DEFECTIVE BULBS
 - REPLACEMENT OF PLUMBING FIXTURES
 - RE-TILING AND WATERPROOFING OF C.R. AT GUESTROOM 2
 - REPAIR OF DAMAGED CEILING AT MEN'S C.R. GROUND FLOOR
 - REPLACEMENT OF OFFICE LABELS, SIGNS AND TAGS

DEVELOPMENT PLAN

SCALE 1:3,100 M

 PHILIPPINE PORTS AUTHORITY PORT MANAGEMENT OFFICE - MARQUEZ	PROJECT LOCATION: MAINTENANCE OF PORT OPERATIONS BUILDING PORT OF LUCENA LUCENA CITY	PREPARED BY:  MARK ANDREW S. PINEDA SENIOR ENGINEER A	REVIEWED/RECOMMENDING APPROVAL:  RAULA LIBATIQUE ACTING ESD MANAGER	APPROVED:  FELITO PORTAJADA PORT MANAGER	SHEET CONTENTS ● DEVELOPMENT PLAN	SHEET NO. 1 / 4
---	--	---	---	--	--------------------------------------	--------------------

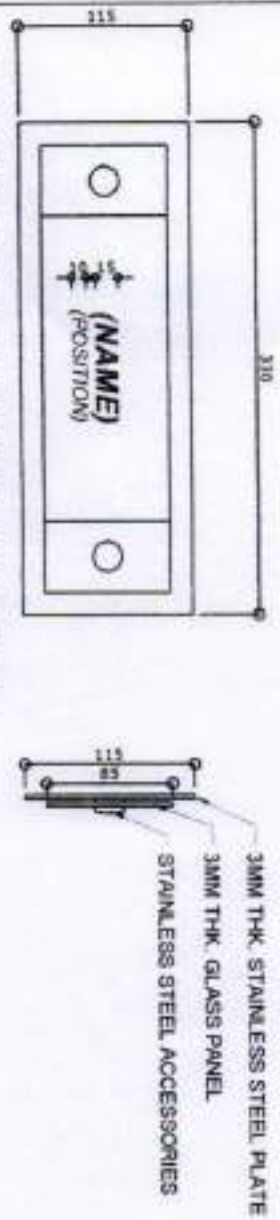

DOOR TAGS (MANAGERS)
13 - UNITS

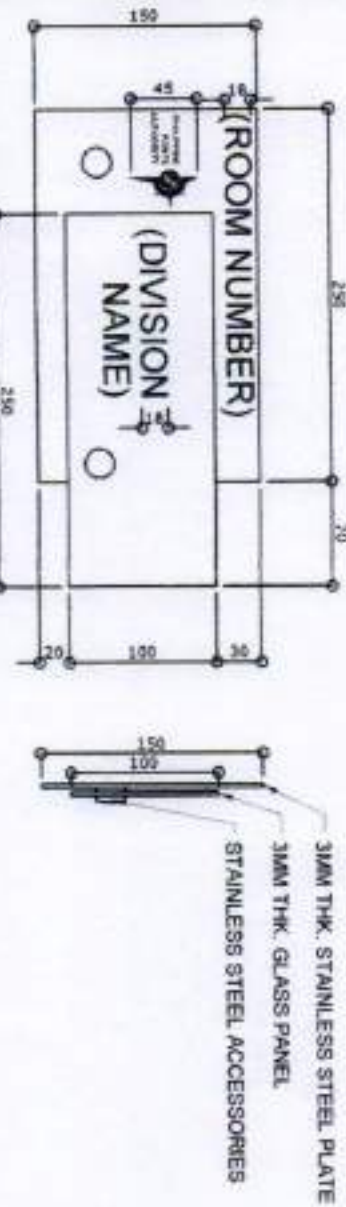

DOOR TAGS (DIVISIONS)
18 - UNITS



TABLE TOP NAME TAGS
10 - UNITS

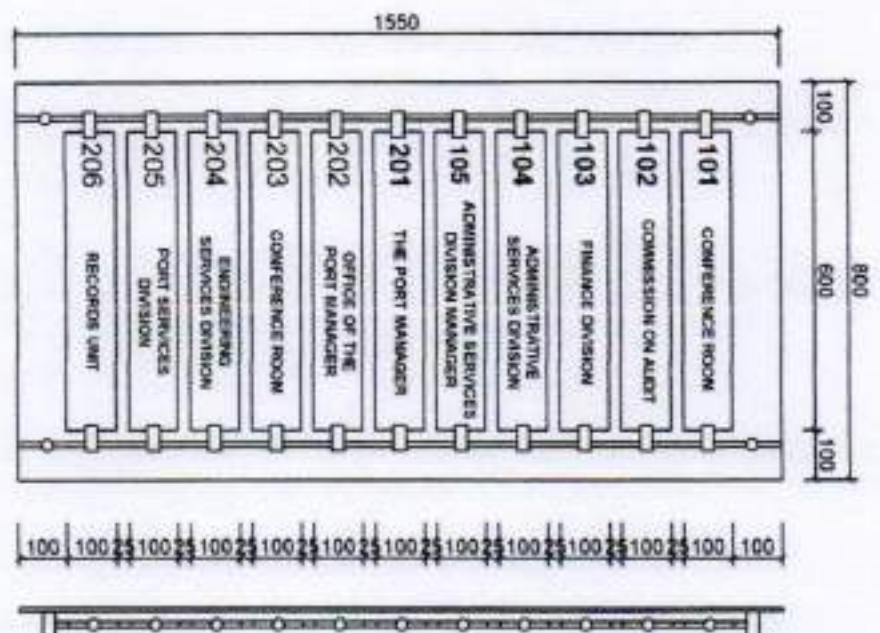
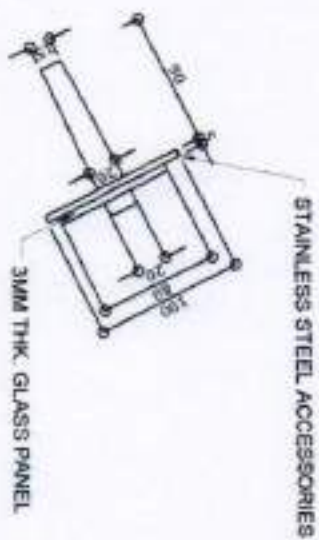

BUILDING DIRECTORY
1 - UNIT

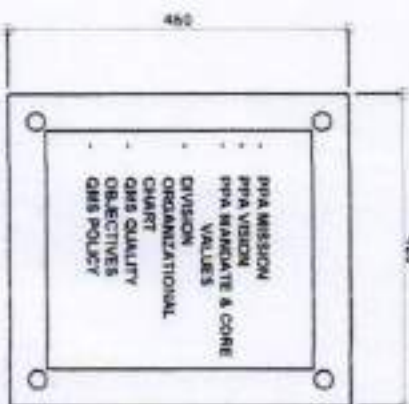

PPA STATEMENTS
48 - UNITS

LIST FOR DOOR TAGS (MANAGERS)

NAME	DESIGNATION
ELUGO P. FORTAJADA	PORT MANAGER
RAUL A. LIBATIQUE	ACTING DIVISION MANAGER
JOEL D. GAVET	DIVISION MANAGER
LAILA A. DE VILLA	DIVISION MANAGER
DAVID A. GREYCOCHEA	ACTING DIVISION MANAGER
LEONARDO C. PANZAL	PSD OFFICER-IN-CHARGE
KEVIN EMANUEL T. LARGADO	BUSINESS DEVELOPMENT/MARKETING OFFICER / ACTING EXECUTIVE SECRETARY
REYNALDO O. FRANCISCO	TERMINAL SUPERVISOR
MARIBETH R. DE LOS SANTOS	CASHER
HONORATO B. DEL MUNDO	ADMINISTRATIVE OFFICER
SHERWIN L. REYES	DIVISION MANAGER
JOEY C. BUENAVALE	DIVISION MANAGER
ISRAEL R. CAMAS	RECORDS OFFICER

LIST FOR DOOR TAGS (DIVISION)

ROOM NUMBER	ROOM NAME
101	CONFERENCE ROOM
102	COMMISSION ON ALLOT
103	FINANCE DIVISION
104	ADMINISTRATIVE SERVICES DIVISION
105	ADMINISTRATIVE SERVICES DIVISION MANAGER
201	THE PORT MANAGER
202	OFFICE OF THE PORT MANAGER
203	CONFERENCE ROOM
204	ENGINEERING SERVICES DIVISION
205	PORT SERVICES DIVISION
206	RECORDS UNIT
	ELECTRICAL ROOM
	ELECTRICAL ROOM
	STORAGE ROOM
	PORT POLICE DIVISION MANAGER
	TERMINAL SECTION
	MARINE SECTION
	CONFERENCE ROOM

LIST FOR TABLE TOP NAME TAGS

NAME	DESIGNATION
ELUGO P. FORTAJADA	PORT MANAGER
RAUL A. LIBATIQUE	ACTING DIVISION MANAGER
JOEL D. GAVET	DIVISION MANAGER
LAILA A. DE VILLA	DIVISION MANAGER
DAVID A. GREYCOCHEA	ACTING DIVISION MANAGER
LEONARDO C. PANZAL	PSD OFFICER-IN-CHARGE
KEVIN EMANUEL T. LARGADO	BUSINESS DEVELOPMENT/MARKETING OFFICER / ACTING EXECUTIVE SECRETARY
REYNALDO O. FRANCISCO	TERMINAL SUPERVISOR
SHERWIN L. REYES	DIVISION MANAGER
JOEY C. BUENAVALE	DIVISION MANAGER

LIST FOR TABLE TOP NAME TAGS

PPA STATEMENT	OFFICE
PPA MISSION	PPA MISSION
PPA VISION	PPA VISION
PPA MANDATE & CORE VALUES	PPA MANDATE & CORE VALUES
ORGANIZATIONAL CHART	ORGANIZATIONAL CHART
QMS QUALITY OBJECTIVES	QMS QUALITY OBJECTIVES
QMS POLICY	QMS POLICY

OFFICE LABELS, SIGNS AND TAGS

<p>PHILIPPINE PORTS AUTHORITY</p> <p>PORT MANAGEMENT OFFICE - MARQUEZ</p>	<p>PROJECT/LOCATION:</p> <p>MAINTENANCE OF PORT OPERATIONS BUILDING</p> <p>PORT OF LUCENA</p> <p>LUCENA CITY</p>	<p>PREPARED BY:</p> <p>MARK ANDREW S. PINEDA</p> <p>SENIOR ENGINEER A</p>	<p>REVIEWED/RECOMMENDING APPROVAL:</p> <p>RAUL A. LIBATIQUE</p> <p>ACTING ESD MANAGER</p>	<p>APPROVED:</p> <p>Mr: ELUGO P. FORTAJADA</p> <p>PORT MANAGER</p>	<p>SHEET CONTENTS</p> <p>● OFFICE LABELS, SIGNS AND TAGS</p>	<p>SHEET NO.</p> <p>2 / 4</p>
---	--	---	---	--	--	-------------------------------

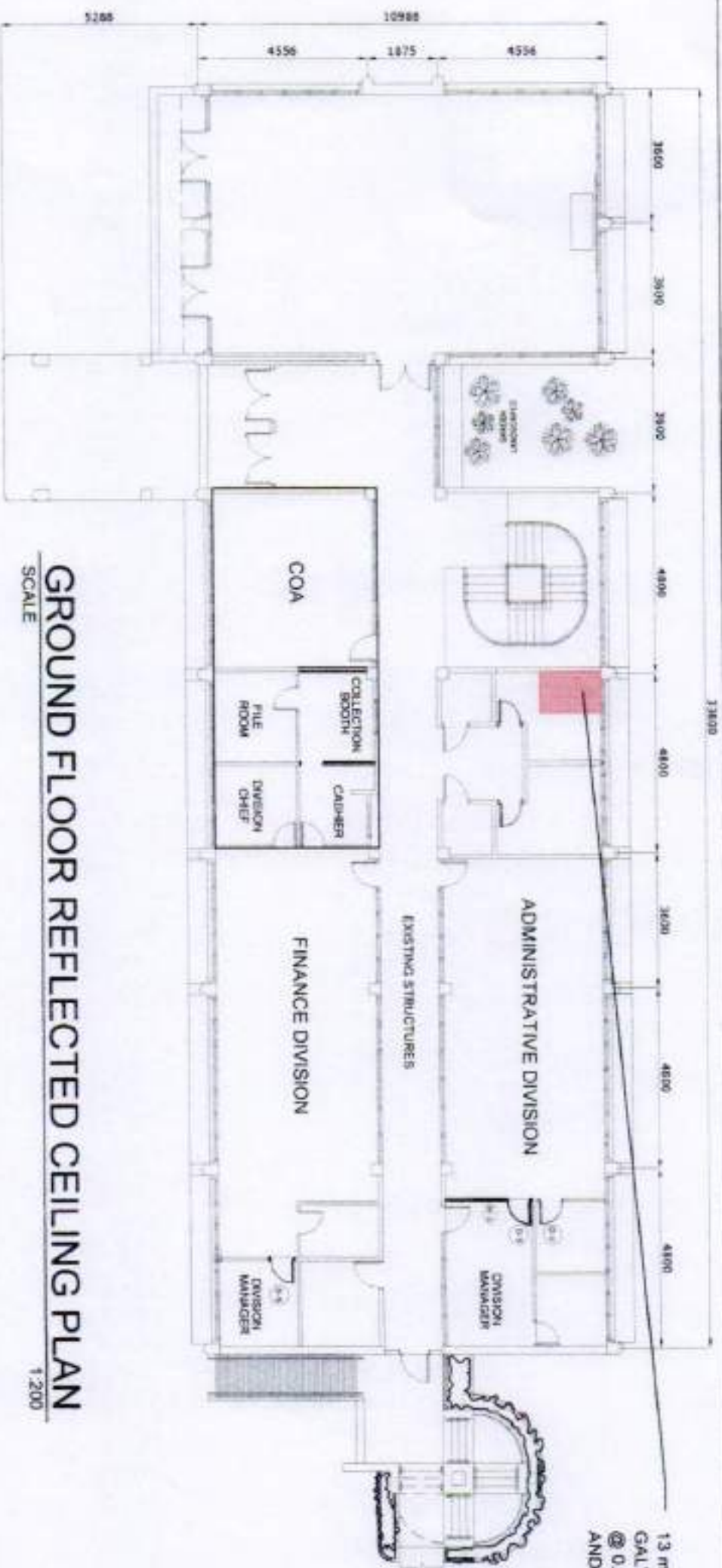

GROUND FLOOR REFLECTED CEILING PLAN
SCALE 1:200

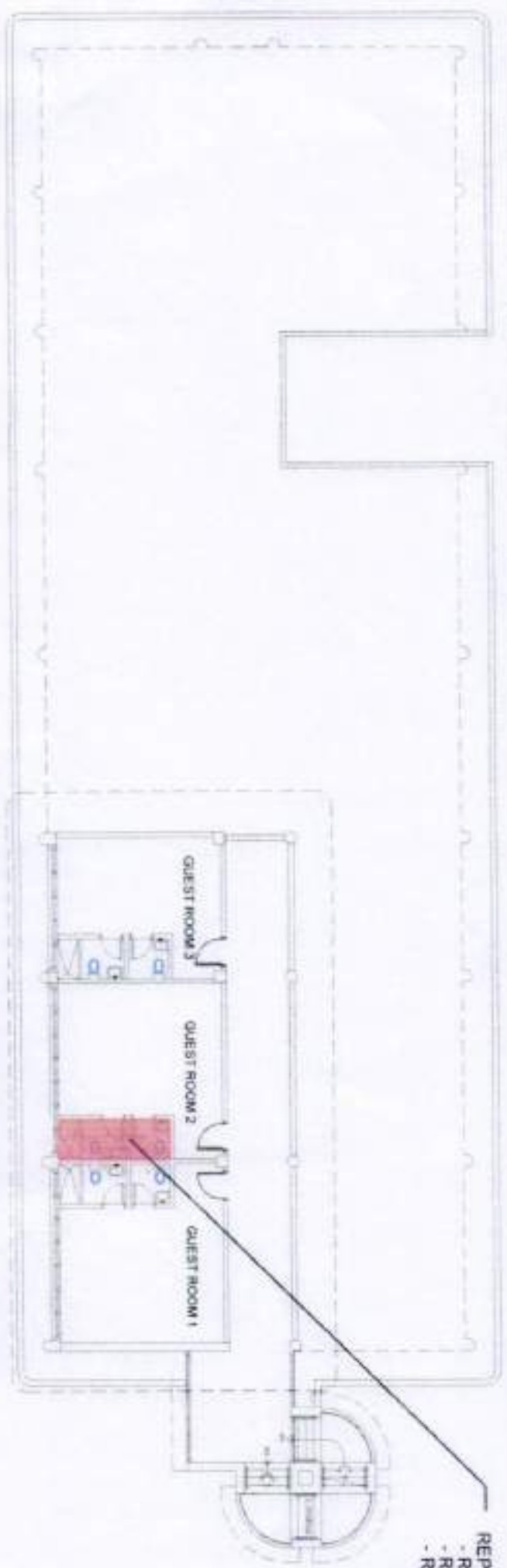

THIRD LEVEL ROOF DECK PLAN
SCALE 1:200

- REPAIR OF C.R. AT GUEST ROOM 2
- RE-APPLICATION OF WATERPROOFING
- RE-TILING WORKS
- REPLACEMENT OF DAMAGED FIXTURES AND FITTINGS

 <p>PHILIPPINE PORTS AUTHORITY PORT MANAGEMENT OFFICE - MARQUEZ</p>	<p>PROJECT/LOCATION: MAINTENANCE OF PORT OPERATIONS BUILDING PORT OF LUCENA LUCENA CITY</p>	<p>PREPARED BY:  MARK ANDREW S. PINEDA SENIOR ENGINEER A</p>	<p>REVIEWED/RECOMMENDING APPROVAL:  RAUL A. LIBATIQUE ACTING SENIOR MANAGER</p>	<p>APPROVED:  MR. ELINDOP FORTAJADA PORT MANAGER</p>	<p>SHEET CONTENTS: ● GROUND FLOOR REFLECTED CEILING PLAN ● THIRD LEVEL ROOF DECK PLAN</p>	<p>SHEET NO. 3 / 4</p>
--	--	---	--	---	---	-----------------------------------

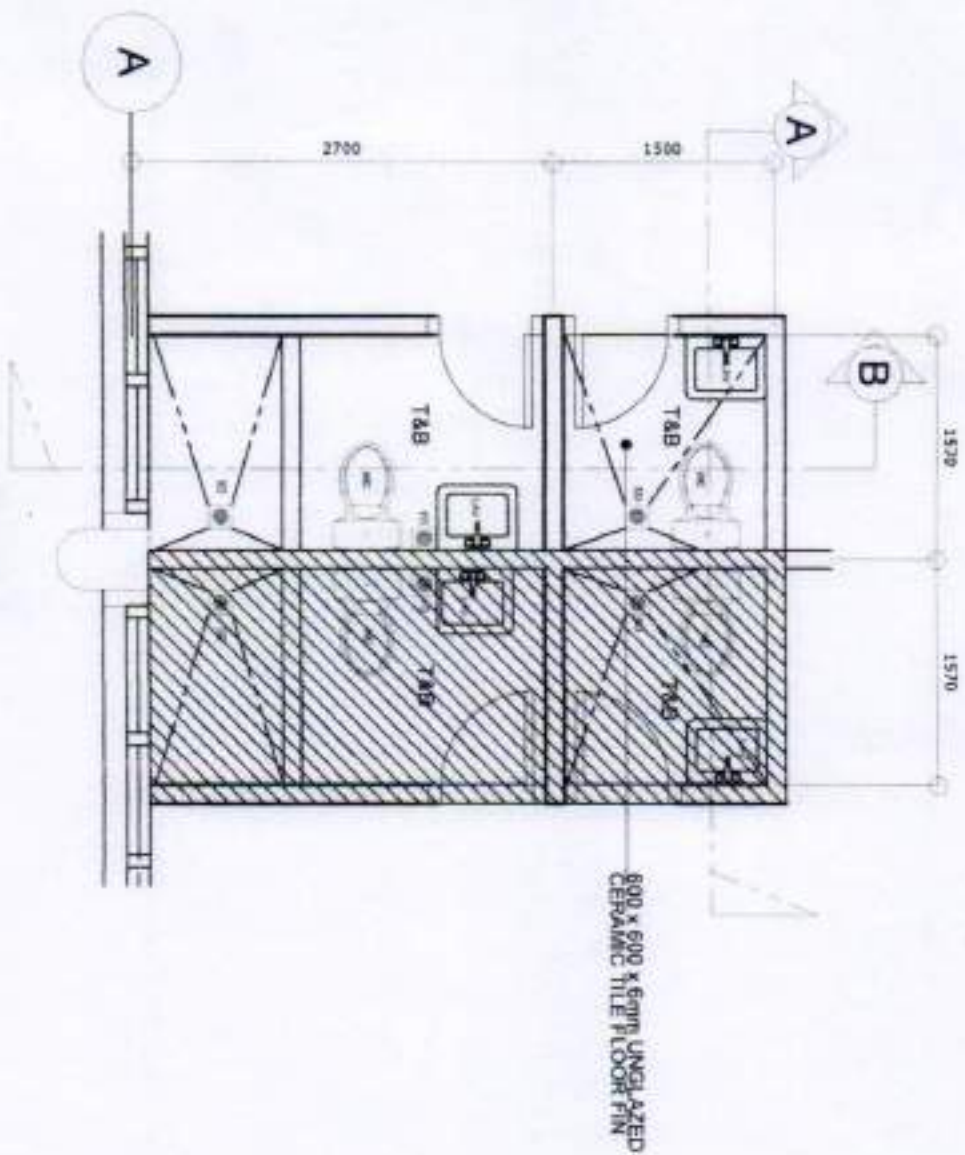

PLAN
SCALE 1:50

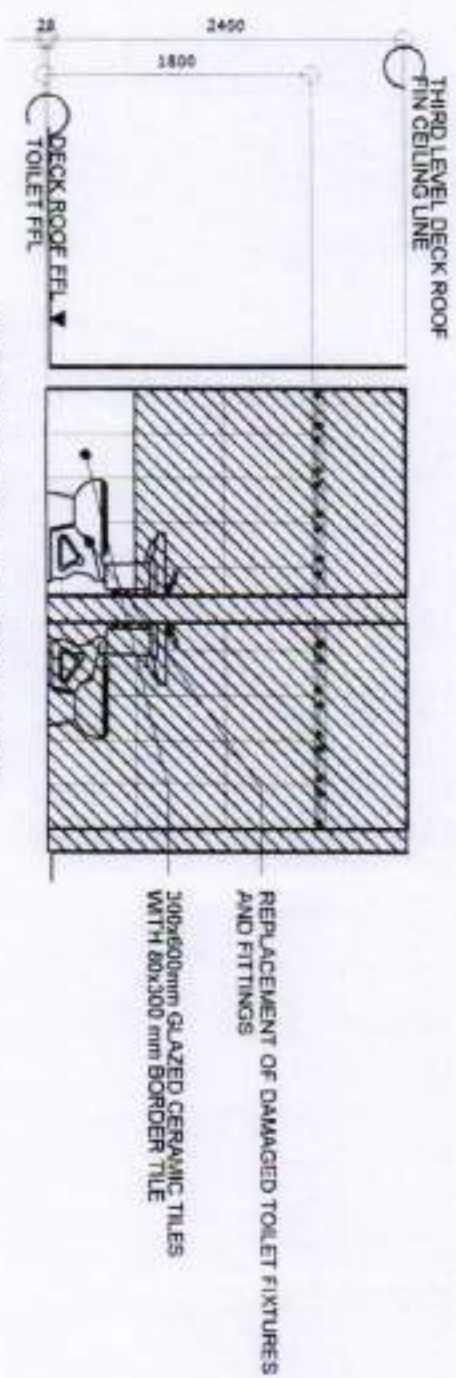

SECTION THRU "A"
SCALE 1:50

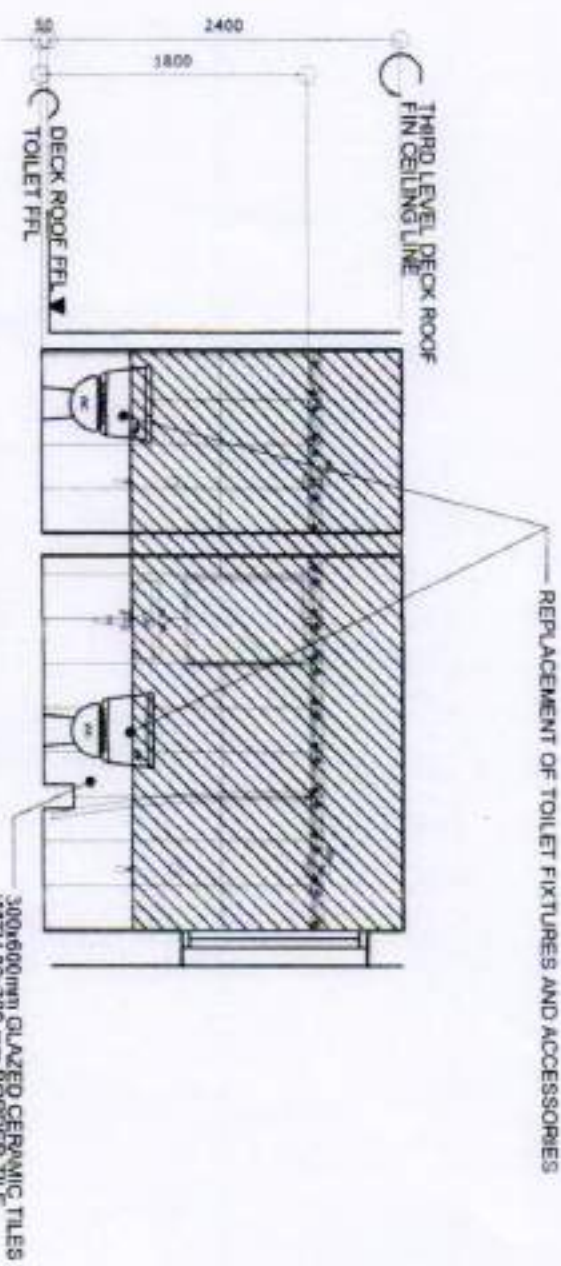

SECTION THRU "B"
SCALE 1:50

TOILET DETAILS @ GUEST ROOM 2

<p>PHILIPPINE PORTS AUTHORITY</p> <p>PORT MANAGEMENT OFFICE - MARQUEZ</p>	<p>PROJECT/LOCATION:</p> <p>MAINTENANCE OF PORT OPERATIONS BUILDING</p> <p>PORT OF LUCENA LUCENA CITY</p>	<p>PREPARED BY:</p> <p>MARK ANDREW S. PINEDA SENIOR ENGINEER A</p>	<p>REVIEWED/RECOMMENDING APPROVAL:</p> <p>RAUL A. LIBATIQUE ACTING ESD MANAGER</p>	<p>APPROVED:</p> <p>FRANCISCO P. FORTAJADA PORT MANAGER</p>	<p>SHEET CONTENTS</p> <p>• TOILET DETAILS AT GUEST ROOM 2</p>	<p>SHEET NO.</p> <p>4 / 4</p>
---	--	--	--	---	---	--------------------------------------