

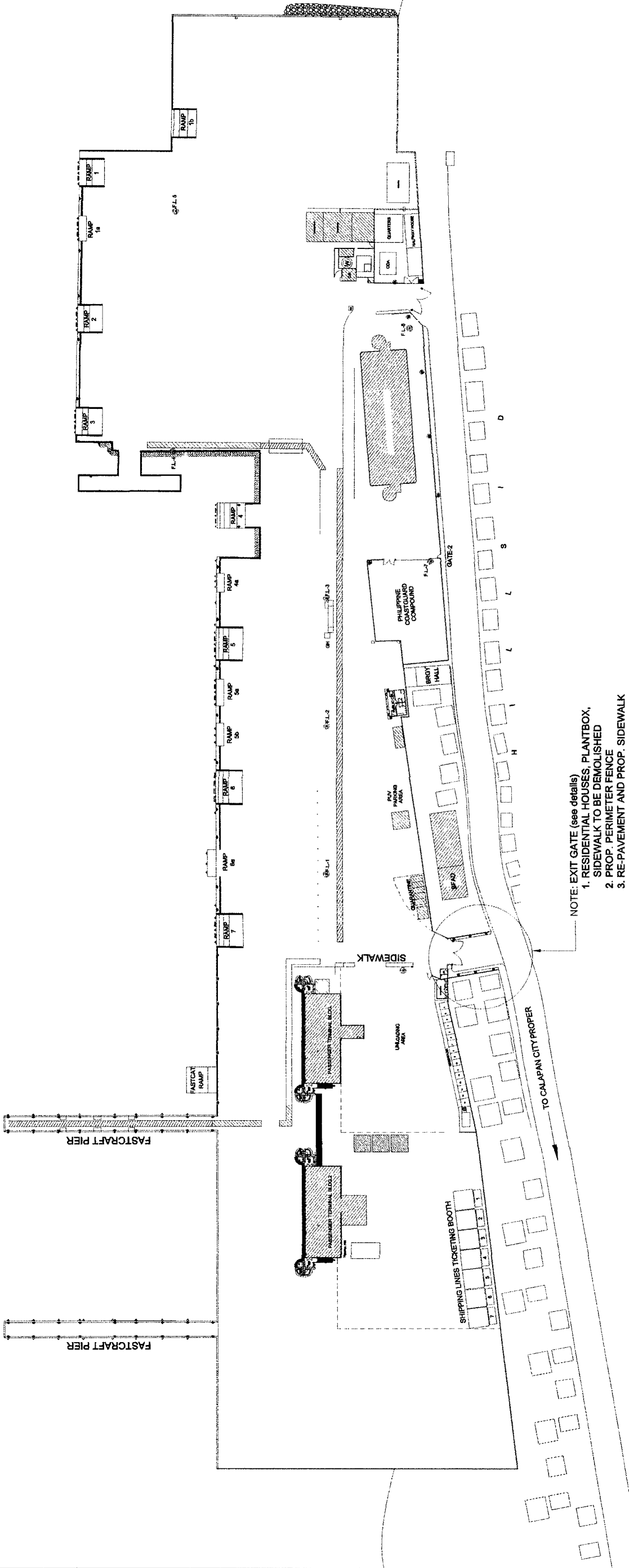



REPAIR OF GATE 1

PORT OF CALAPAN, ORIENTAL MINDORO



PORT LAYOUT PLAN
PORT OF CALAPAN
ORIENTAL MINDORO

SCALE : 1:1,500 M.



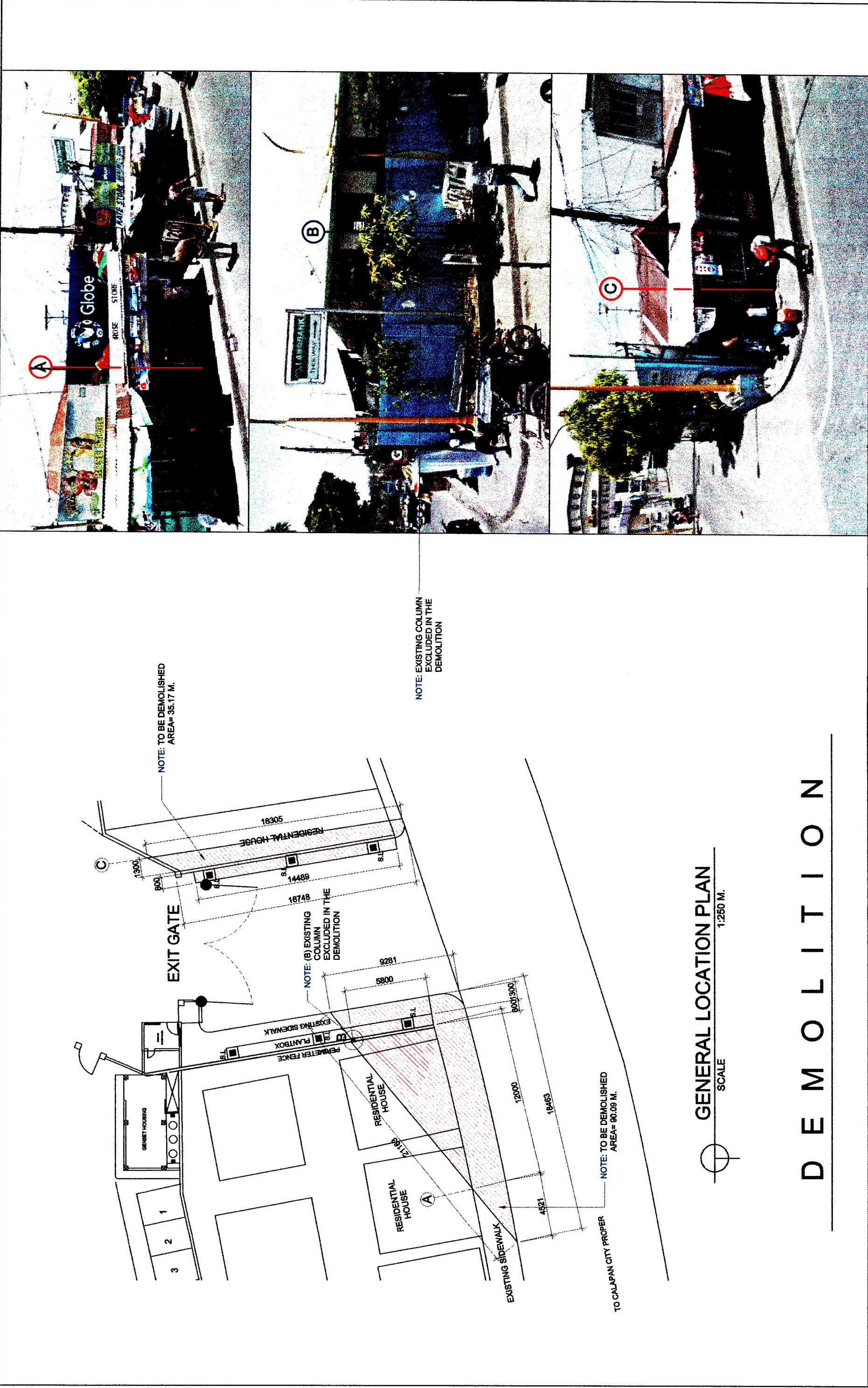



 <div>PHILIPPINE PORTS AUTHORITY PMO-MINDORO</div>	PROJECT TITLE: REPAIR OF GATE 1 PORT OF CALAPAN, ORIENTAL MINDORO				SHEET CONTENTS: AS SHOWN		SCALE: AS SHOWN	
	PREPARED BY: ROMELL C. MALUBAY Draftsman	SUBMITTED BY: CONRADO E. CASAPAO JR. Assistant Port Engineer	CHECKED / REVIEWED BY: RONALDO O. MAYIBAG Supervising Engineer A	RECOMMENDING APPROVAL BY: MARGARITO P. DIMALIG Acting Division Manager A, ESD	APPROVED BY: ELVIS R. MEDALLA Port Manager A	SHEET NO. 1 of 7	DATE: 07 MARCH, 2019	



GENERAL LOCATION PLAN

SCALE 1:250 M.

DEMOLITION

 PHILIPPINE PORTS AUTHORITY PMO- MINDORO	PROJECT TITLE: REPAIR OF GATE 1 PORT OF CALAPAN, ORIENTAL MINDORO				SHEET CONTENTS:		SCALE: AS SHOWN	
	PREPARED BY:  ROMELL C. MALUBAY Draftsman	SUBMITTED BY:  CONRADO E. CASAPAO JR. Assistant Port Engineer	CHECKED / REVIEWED BY:  RONALD O. MATIBAG Supervising Engineer A	RECOMMENDING APPROVAL BY:  MARGARITO P. DIMALIG Acting Division Manager A, ESD	APPROVED BY:  ELVIS R. MEDALLA Port Manager A	AS SHOWN		SHEET NO. 2 of 7
							DATE :	
							07 MARCH, 2019	

RE - PAVEMENT

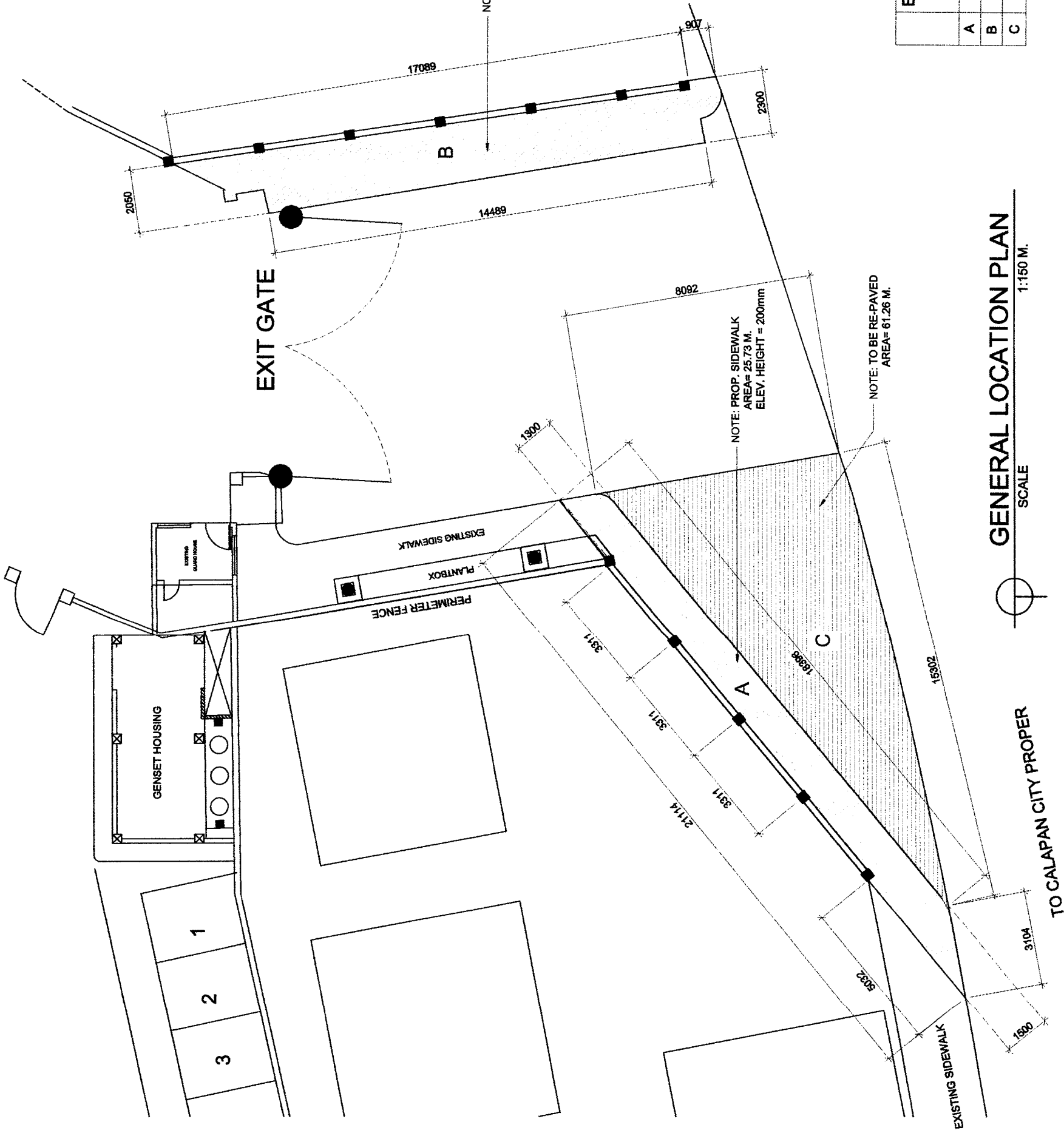

SIDEWALK

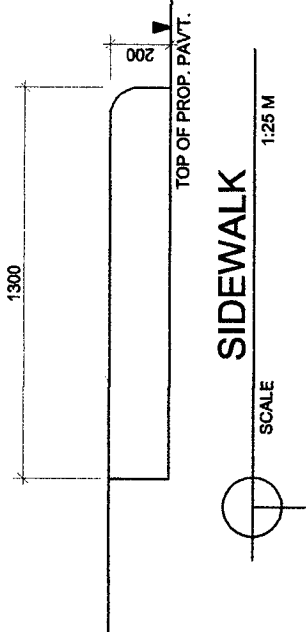

ELEV. FROM EXISTING PAVT	CONC. SLAB	GRAVEL BASECOURSE	BARS
A 200mm	300mm	200mm	10mmØ @ EVERY 600mm OC. BW.
B 0mm	250mm	200mm	16mmØ @ EVERY 600mm OC. BW.
C 0mm	250mm	200mm	16mmØ @ EVERY 600mm OC. BW.

GENERAL LOCATION PLAN

SCALE 1:150 M.



PMO-MINDORO

PREPARED BY:
ROMELL C. MALUBAY
Draftsman

SUBMITTED BY:
CONRADO E. GASAPAO JR.
Assistant Port Engineer

CHECKED / REVIEWED BY:
RONALD O. MADIBAG
Supervising Engineer A

RECOMMENDING APPROVAL BY:
MARGARITO P. DIMALIG
Acting Division Manager A, ESD

APPROVED BY:
ELVIS R. MEDALLA
Port Manager A

SHEET CONTENTS:
AS SHOWN

SCALE:
AS SHOWN

SHEET NO.
4 of 7

DATE:
07 MARCH, 2019

NOTE: PERIMETER FENCE TO BE PAINT
(PRIMERCOAT WITH TWO TOP COAT OF ELASTOMERIC PAINT)

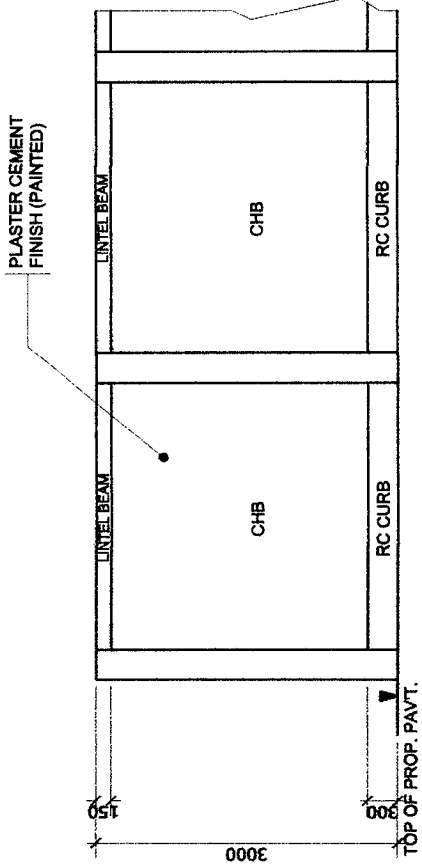
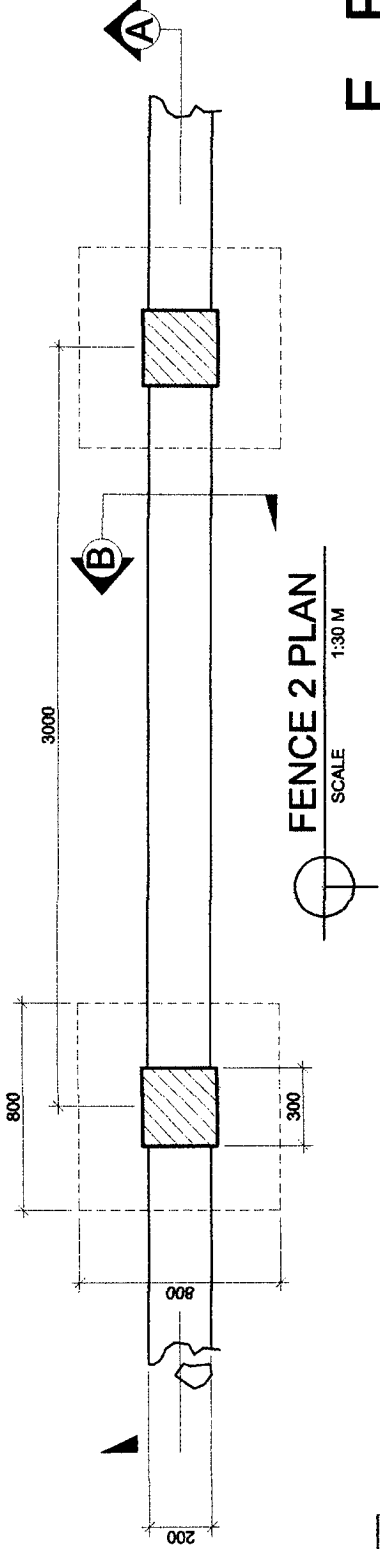

TYP. FENCE 1 ELEVATION

SCALE 1:75 M

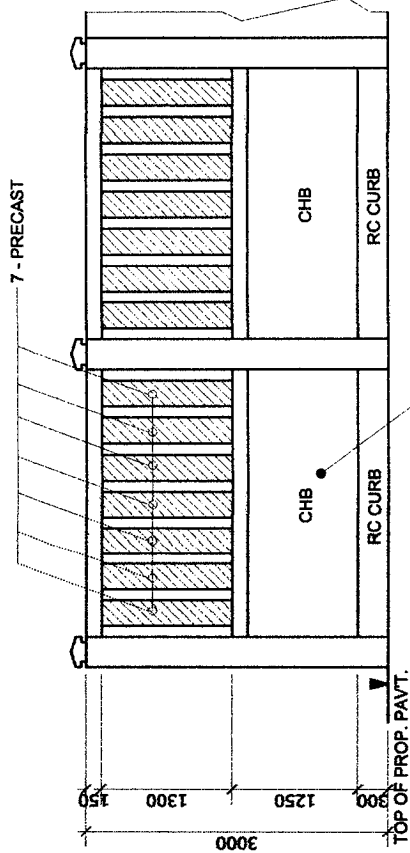

TYP. FENCE 2 ELEVATION (PRE-CAST)

SCALE 1:75 M

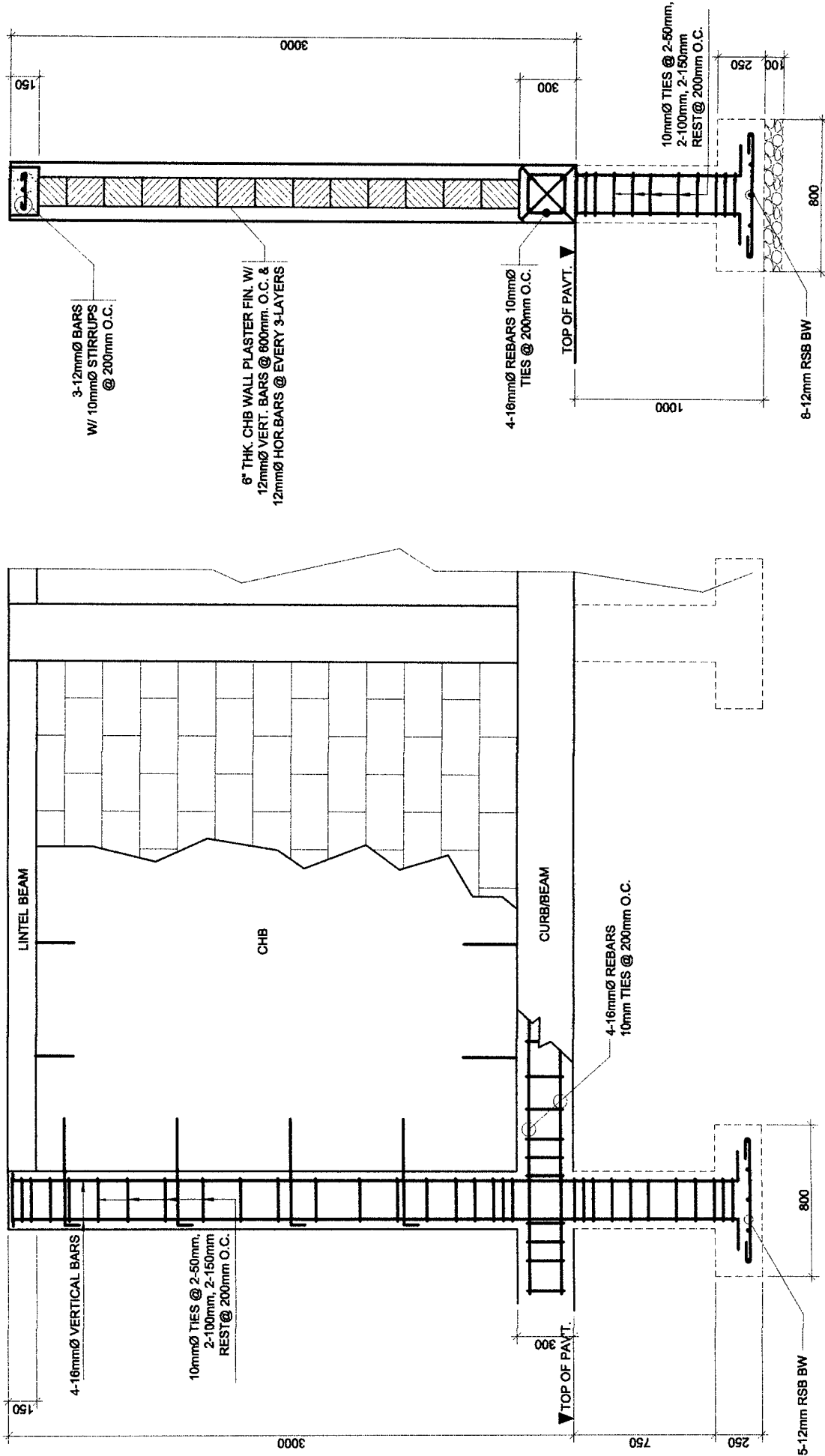

PHILIPPINE
PORTS
AUTHORITY
PMO- MINDORO

PROJECT TITLE: REPAIR OF GATE 1
PORT OF CALAPAN, ORIENTAL MINDORO

PREPARED BY:
ROMELL C. MALLUBAY
Draftsman

SUBMITTED BY:
CONRADO E. CASAPAO JR.
Assistant Port Engineer

CHECKED / REVIEWED BY:
RONALD O. MATBAG
Supervising Engineer A

RECOMMENDING APPROVAL BY:
MARGARITO P. DIMALLIG
Acting/Division Manager A, ESD

APPROVED BY:
ELVIS R. MEDALLA
Port Manager A

SHEET CONTENTS:
AS SHOWN

SCALE: AS SHOWN

SHEET NO.
5 of 7

DATE:

07 MARCH, 2019

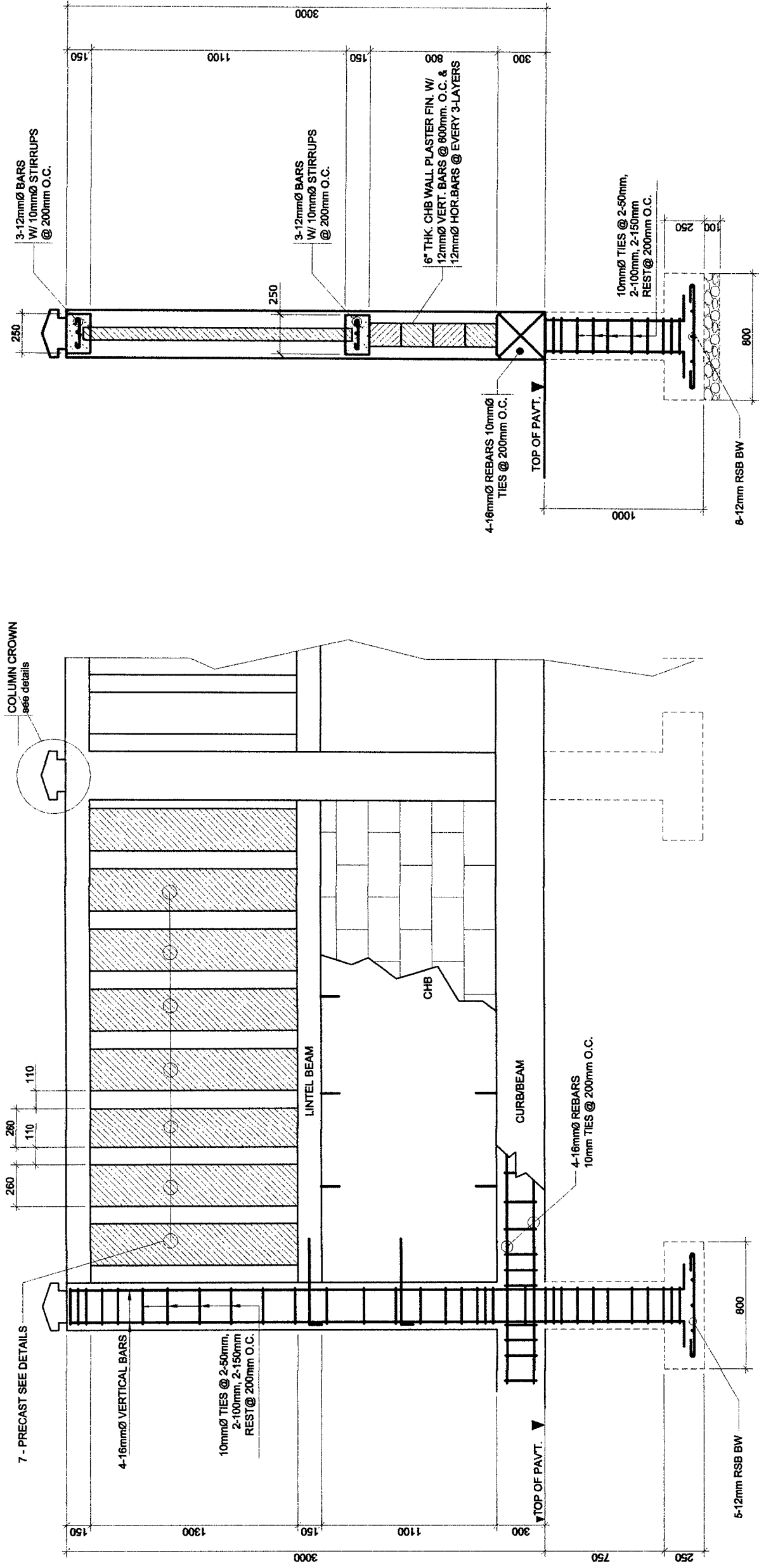

SECTION THRU "A"
SCALE 1:30 M

SECTION THRU "B"
SCALE 1:30 M

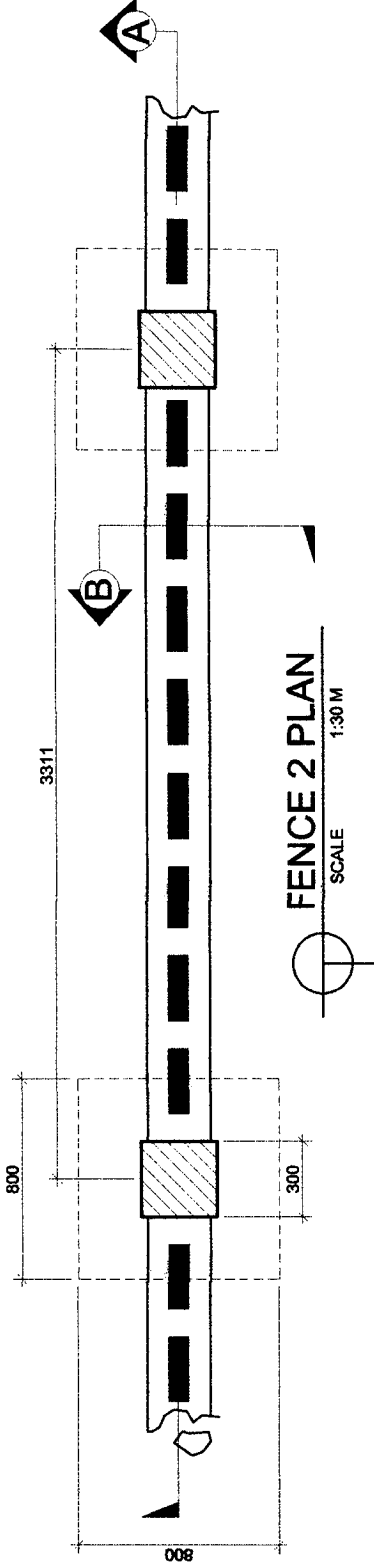

FENCE 2 PLAN
SCALE 1:30 M

FENCE 2

NOTE: PERIMETER FENCE TO BE PAINT
(PRIMER COAT WITH TWO TOP COAT OF ELASTOMERIC PAINT)



PROJECT TITLE: REPAIR OF GATE 1
PORT OF CALAPAN, ORIENTAL MINDORO

PREPARED BY:
ROMELL C. MALUBAY
Draftsman

SUBMITTED BY:
CONRADO E. GASAPAO JR.
Assistant Port Engineer

CHECKED / REVIEWED BY:
RONALD O. MATIBAG
Supervising Engineer A

RECOMMENDING APPROVAL BY:
MARGARITO P. DIMAUG
Acting Division Manager A, ESD

APPROVED BY:
ELVIS R. MEDALLA
Port Manager A

SHEET CONTENTS: AS SHOWN
SCALE: AS SHOWN
SHEET NO. 6 of 7
DATE: 07 MARCH, 2019

12mmØ BARS W/ 10mmØ
STIRRUPS @ 200MM O.C.

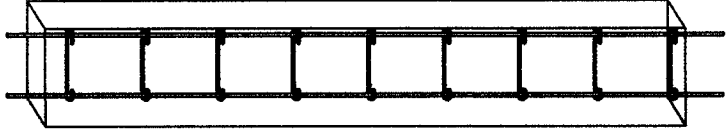
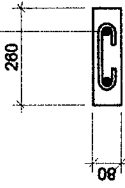

ISOMETRIC

TYPICAL
PRE-CAST DETAIL

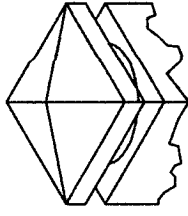
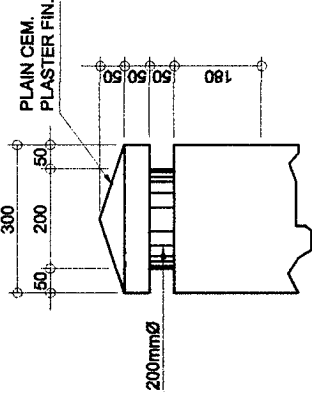

ISOMETRIC
VIEW

COLUMN CROWN DET.

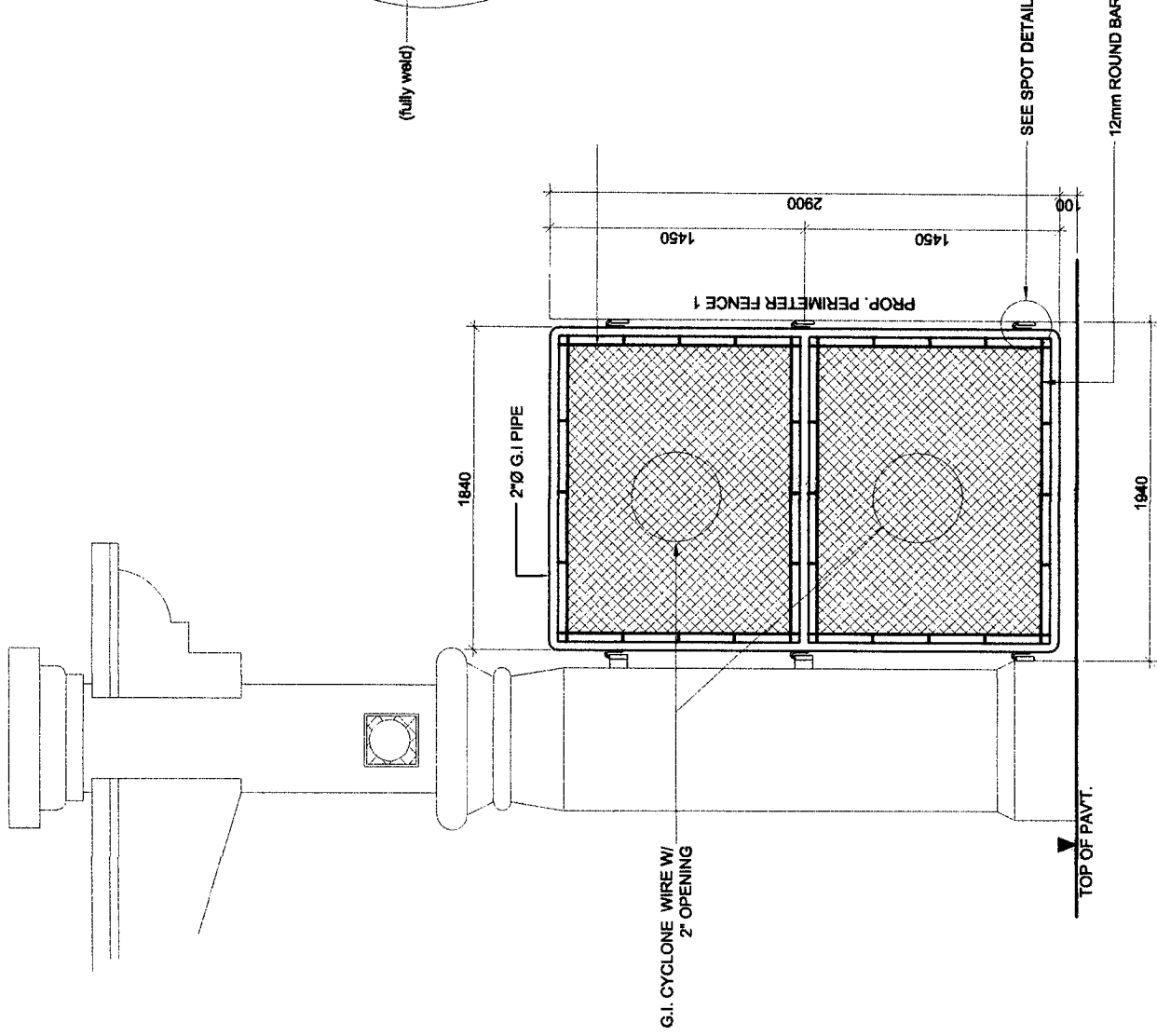

TEMPORARY STEEL FENCE

SCALE 1:20 M

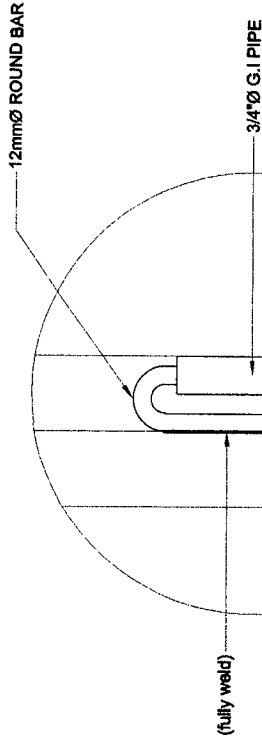

SPOT DETAILS

NOTE: STEEL FENCE TO BE PAINT
(EPOXY PRIMER WITH TOP COAT OF EPOXY ENAMEL PAINT)



PROJECT TITLE: REPAIR OF GATE 1
PORT OF CALAPAN, ORIENTAL MINDORO

PREPARED BY:
ROMELL C. MALLUBAY
Draftsman

SUBMITTED BY:
COMARDO E. GASAPAO JR.
Assistant Port Engineer

CHECKED / REVIEWED BY:
RONALD O. MATBAG
Supervising Engineer A

RECOMMENDING APPROVAL BY:
MARGARITO P. DIMANIG
Acting Division Manager A, ESD

APPROVED BY:
ELVIS R. MEDALLA
Port Manager A

SHEET CONTENTS:
AS SHOWN

SCALE:
AS SHOWN

SHEET NO.
7 of 7

DATE:
07 MARCH, 2019