

SITE DEVELOPMENT PLAN

SCALE:

1:2500MTS.

- LIST OF DRAWINGS
- 1 OF 3 SITE DEVELOPMENT PLAN
 - 2 OF 3 FLOOR PLAN
 - 3 OF 3 CEILING LAYOUT PLAN

DETAIL OF TEMPORARY GENSET ROOFING
FENCE DETAIL

PROJECT TITLE: MAINTENANCE OF PTB, GUARD HOUSE, FENCE AND TEMPORARY GENSET HOUSE AT PORT OF CLAVERIA CAGAYAN

PHILIPPINE
PORTS
AUTHORITY

PORT AUTHORITY
ENGINEERING SERVICES DIVISION

APPROVED BY:

ANGELITO R. ELLINO
DISTRICT ENGINEER III

CHECKED BY:

RYAN B. MERCADO
SUPERVISING ENGINEER A

REVIEWED BY:

DEMOSTHENES P. FERRARO
PRINCIPAL ENGINEER

RECOMMENDED BY:

CRISANTO A. ALBA
DISTRICT MANAGER

APPROVED BY:

MARILETA G. ODICTA
PRINCIPAL PORT-NORTHERN LUZON

SHEET NO.

1 OF 3

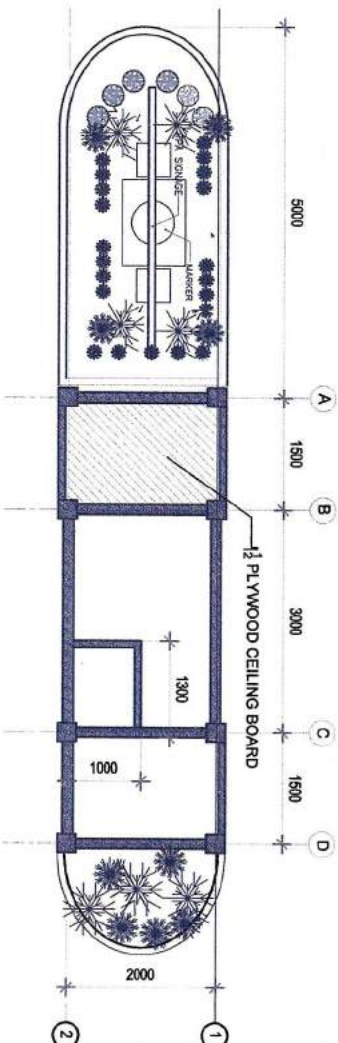

CEILING LAYOUT PLAN
SCALE 1 : 30

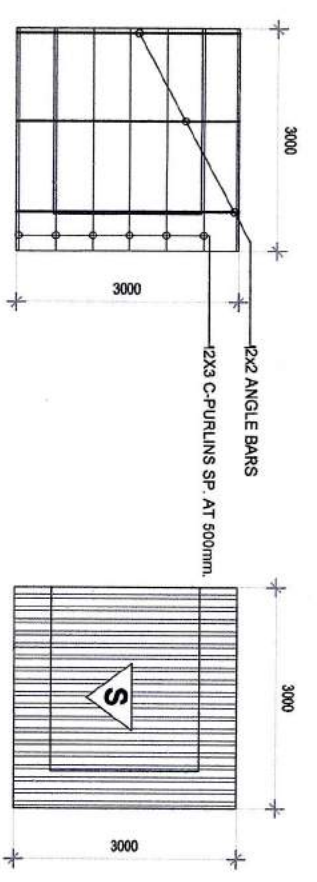

DETAIL OF TEMPORARY GENSET ROOFING
SCALE 1 : 30

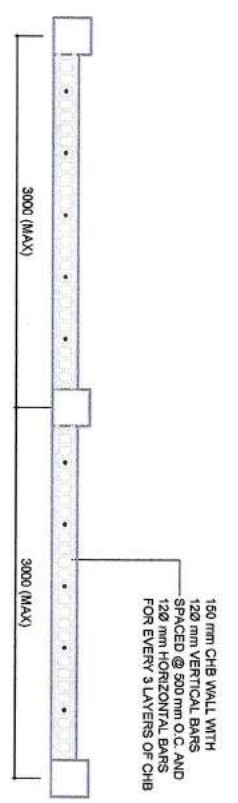

TYPICAL PLAN OF CHB FENCE
SCALE 1 : 30

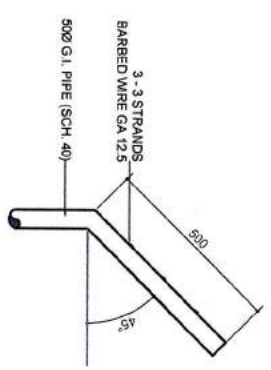

DETAIL "J"
SCALE 1 : 10

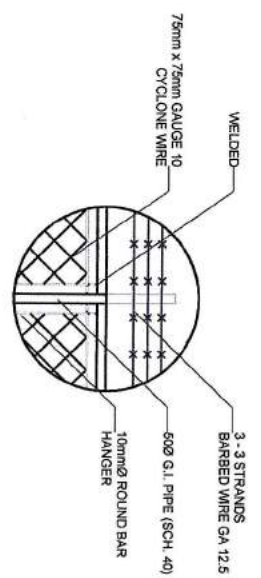

DETAIL "M"
SCALE 1 : 20

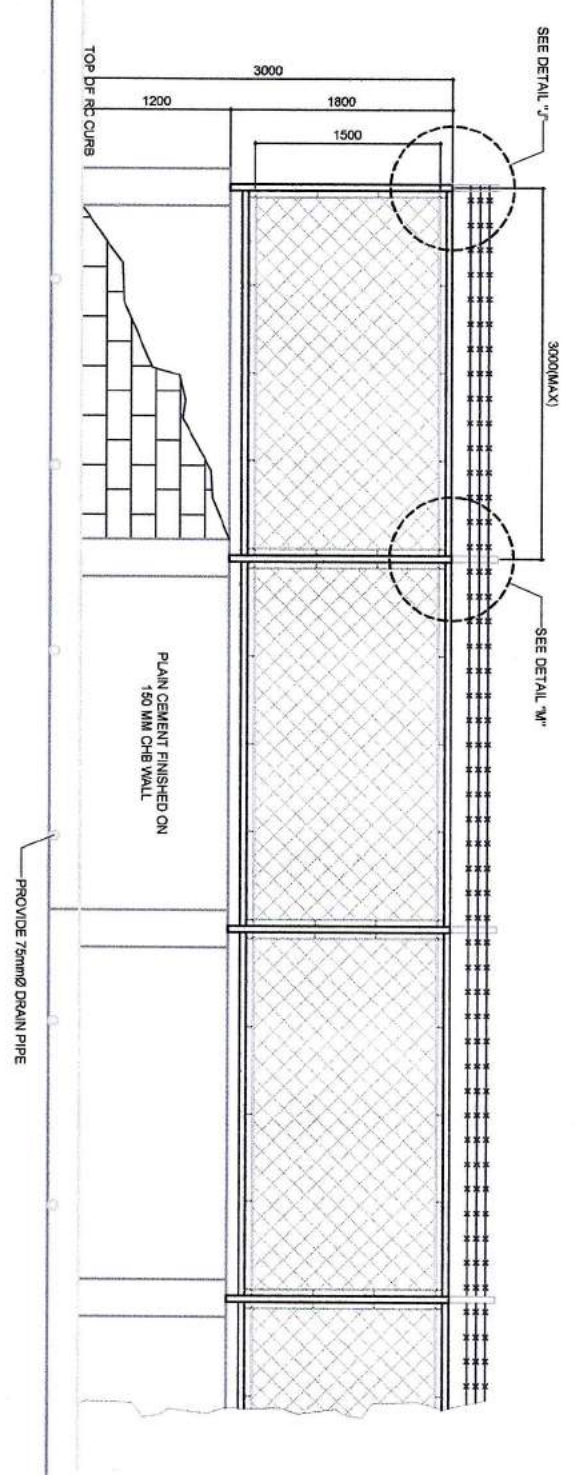

TYPICAL ELEVATION OF CHB FENCE
SCALE 1 : 30

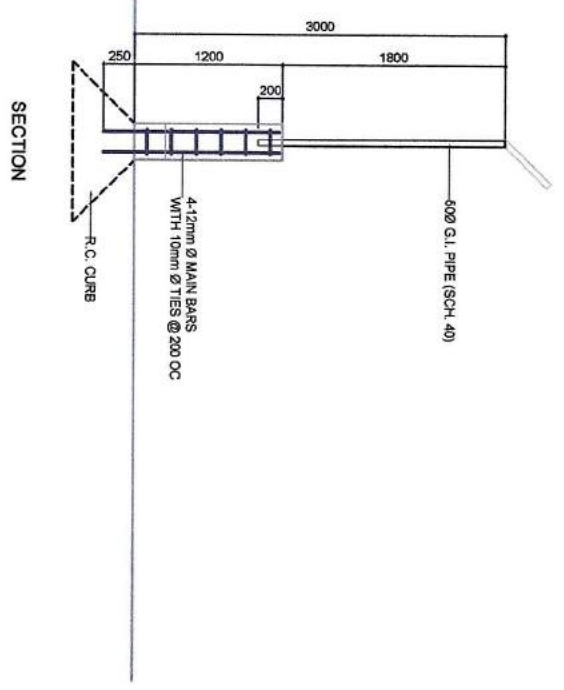

DETAIL OF COLUMN/RETAINING WALL
SCALE 1 : 30



PROJECT TITLE: MAINTENANCE OF PTB, GUARD HOUSE, FENCE AND TEMPORARY GENSET HOUSE AT PORT OF CLAVERIA CAGAYAN			
DESIGNED BY: ANGELO REY C. EPINO	CHECKED BY: RYAN B. MERCADO	REVIEWED BY: DEMOS BENENES P. FERRARO	RECOMMENDED BY: CRISANTO A. ALBA
DATE: 15/04/2024	DATE: 15/04/2024	DATE: 15/04/2024	DATE: 15/04/2024
SHEET NO. 3 OF 3			