

LOCATION MAP

GENERAL NOTES:

1. ALL SOUNDING ELEVATION SHALL BE IN METERS RECKONED FROM MEAN LOWER LOW WATER (MLLW) OF 00.00 ELEVATION;
2. INDICATE IN THE PLAN THE LOCATION AND THE VERTICAL CONTROL ADOPTED IN THE SURVEY;
3. SHOW GRID COORDINATES IN THE FINAL SURVEY PLAN (PHILIPPINE PLANE COORDINATE SYSTEM - TRANSVERSE MERCATOR / PHILIPPINE REFERENCE SYSTEM OF 1992);
4. INDICATE IN THE FINAL SURVEY PLAN THE INSTRUMENTS/S AND SOFTWARE/S USED.
5. CONTOUR INTERVAL MUST BE AT LEAST:
5.00m - FOR TOPOGRAPHIC SURVEY
20.00m - FOR HYDROGRAPHIC SURVEY
6. DIMENSIONS ARE IN METERS UNLESS SPECIFIED

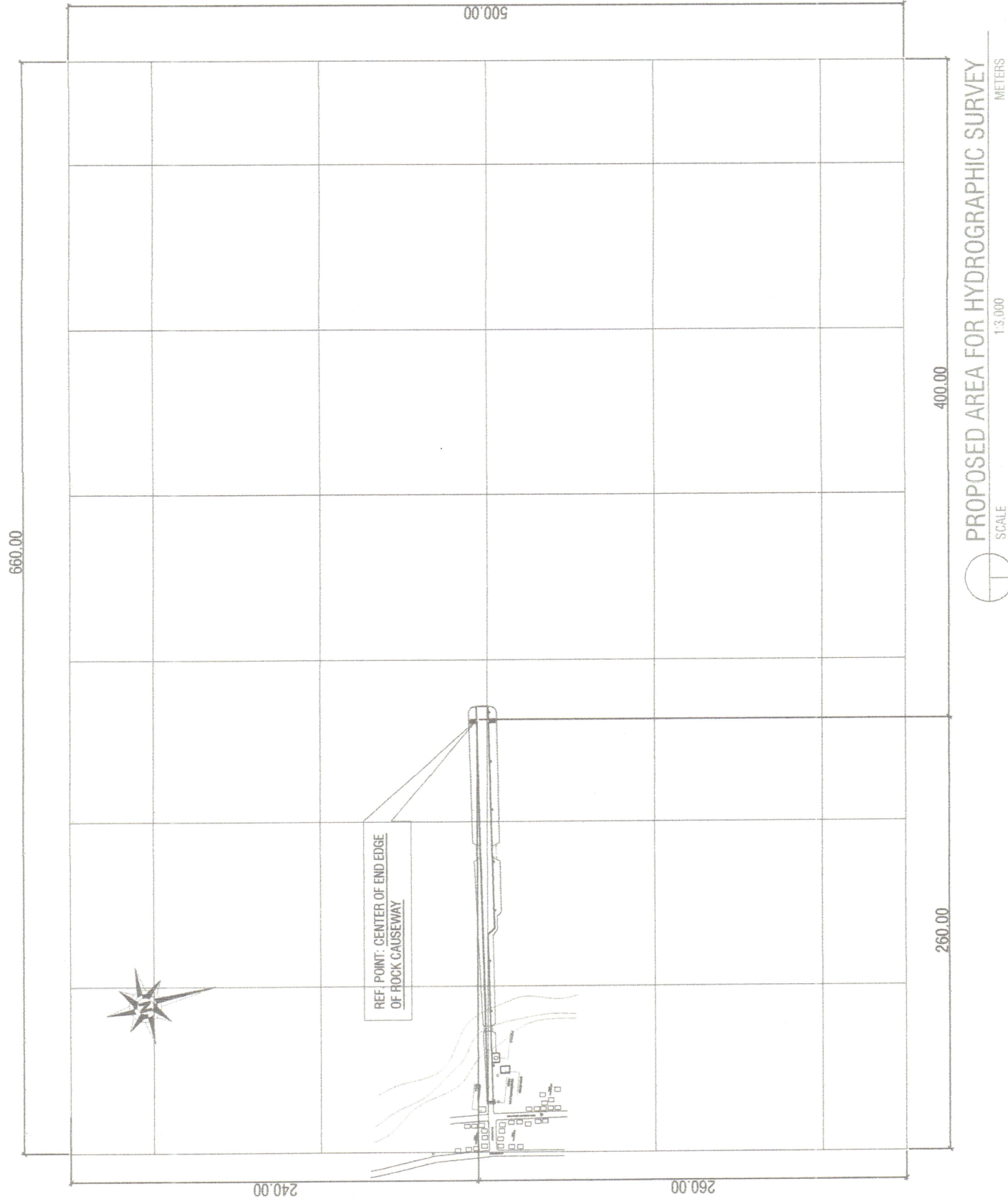

PROPOSED AREA FOR HYDROGRAPHIC SURVEY

METERS

PROJECT TITLE AND LOCATION:

PHILIPPINE
PORTS
AUTHORITY

PROPOSED HYDROGRAPHIC & TOPOGRAPHIC SURVEY OF PORT AGUTAYA

DRAWN BY:

RELLY W. MADARCOS
SENIOR ENGINEER A

PREPARED BY:

NELSON Y. CAABAY
PRINCIPAL ENGINEER A

~~RECOMMENDING / APPROVAL:~~

MARLON N. SENDAYDIEGO
ESD MANAGER

APPROVED BY:

ELIZALDE M. ULSON
ACTING PORT MANAGER

SHEET CONTENTS

FILE NAME:

SHEET NO.