

PERSPECTIVE

SPECIFICATION:

- STAINLESS STEEL SIGNAGE: 1.90 x 1.35mts.
- LASER CUT STAINLESS STEEL 304
- HAIRLINE FINISH w/ 2" STAINLESS STEEL SIDINGS
- VERTICAL TUBULAR FRAME: 2.45 x 4.49mts.
- 1.50mm thk. x 50 x 100 TUBULAR STEEL
- AUTOMOTIVE PAINT FINISH (Color:black)
- HANGING TRACKLIGHT
- 1.50mm thk. 50 x 50 TUBULAR STEEL FRAME
- FIXED HANGER ROD WIRE SLINGS
- 2m TRACK BAR LIGHT RAIL & ACCESSORIES
- 20w TRACK LIGHT (Color:Warm White)

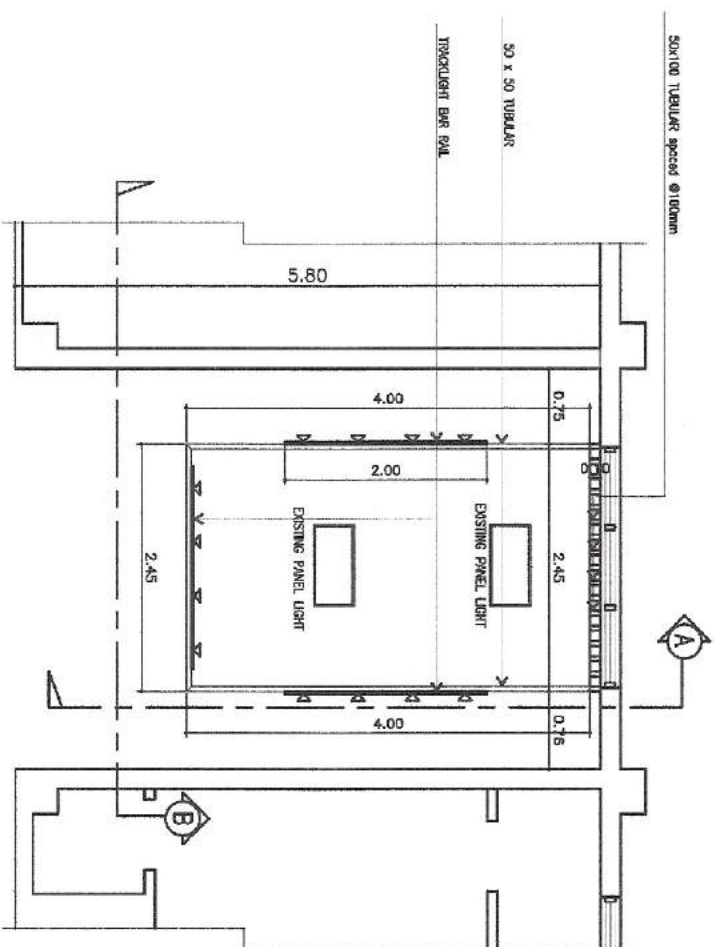
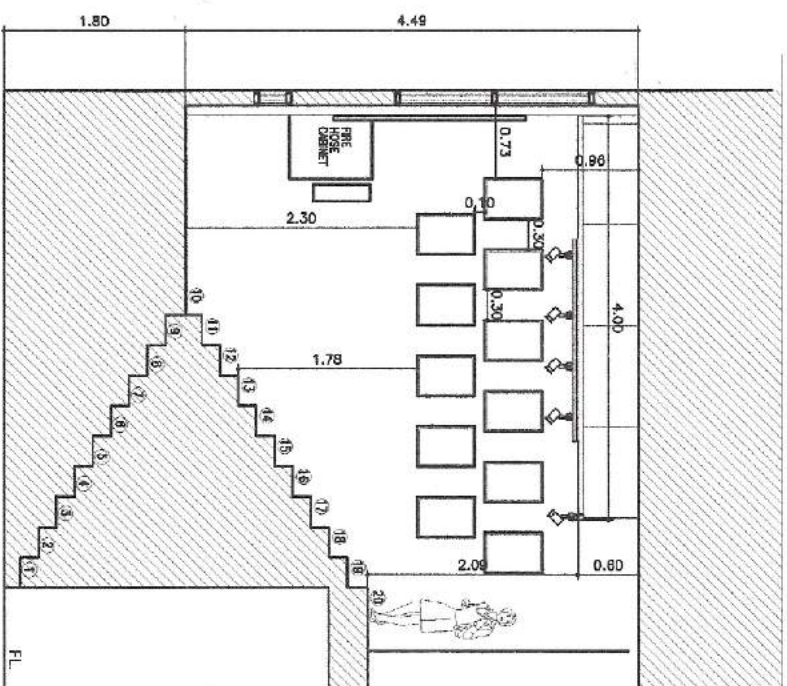

HANGING TRACKLIGHT THRU "A"

SCALE 1:50 METERS

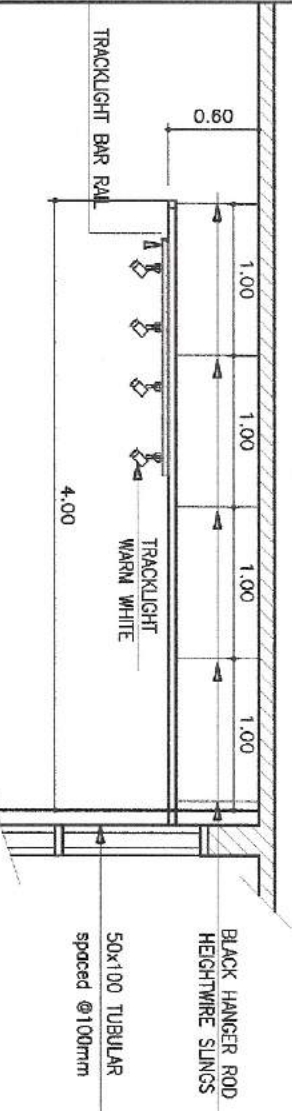

HANGING TRACKLIGHT THRU "B"

SCALE 1:50 METERS

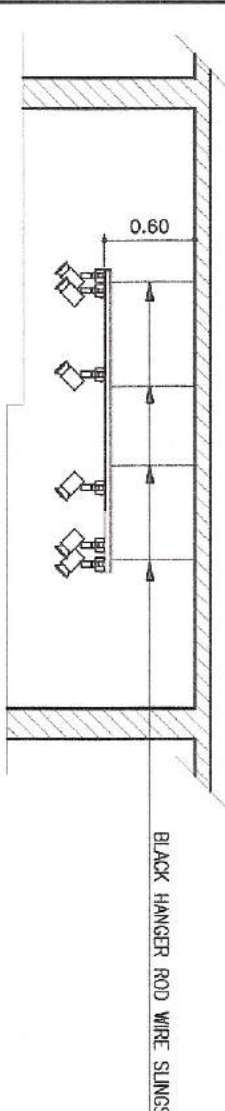

PROJECT TITLE: PROPOSED PORT MANAGER'S PHOTO GALLERY AT PMO-NCR NORTH ADMINISTRATION BUILDING, NORTH HARBOR, TONDO, MANILA

PREPARED BY:

REVIEWED & SUBMITTED BY:

APPROVED:

SHEET CONTENT:

SHEET NO.

PORT MANAGEMENT OFFICE-
NCR NORTH

JEFERTE LILAN
Architect

JOENEL D. MANALON
Principal Engineer A

ANNE LEE F. MANESE
Manager, PMO-NCR NORTH

AS SHOWN

2

